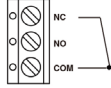
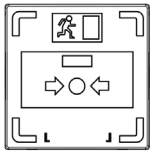
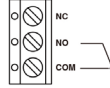
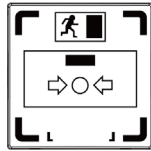

## 1] PRODUCT PRESENTATION

Feature	Description
Material	ABS, PC (lid)
Power Supply	12-24Vdc (+/- 10%)
Consumption (+/- 10%)	Standby: 20mA Operation: 40mA
Outputs	3 x NO/NC/COM
Dual color LEDs	Green: Standby Red: operation
Dimensions	90 (L) x 95 (W) x 45 (D) mm
Weight	0.17 kg

**STANDBY**  
 Status LED: Green

**OPERATION**  
 Status LED: Red

CE Certification



UKCA Certification



WEEE &amp; RoHS



## 3] PACKAGE CONTENTS

Unit	Key	PA4	Screws
1	1	30	4

## 4] WIRING AND CONNECTIONS

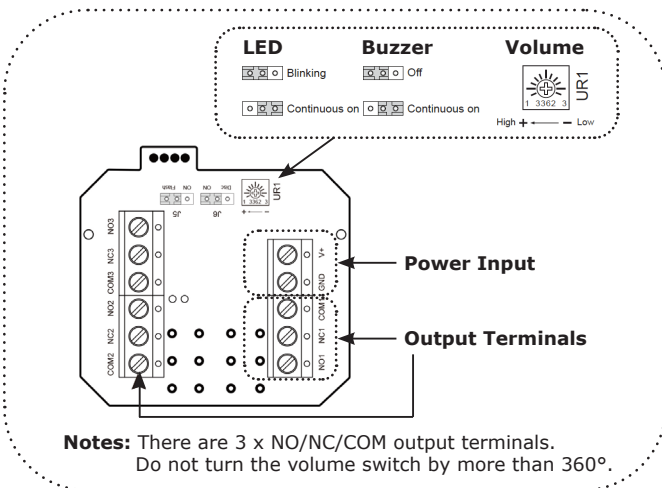

## 2] INSTALLATION

**ATTENTION**

Press the drop plate to make sure the LEDs turn red before opening the front and middle covers in order to prevent the spring from popping out.

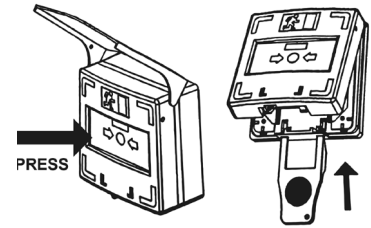
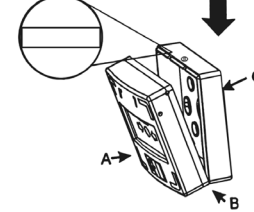
**1**

Remove the screws, then remove the fasteners B and C.

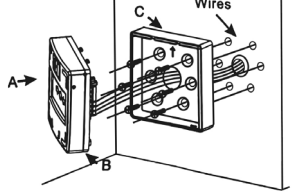
**2**

Fix the backbox C and connect the wires.

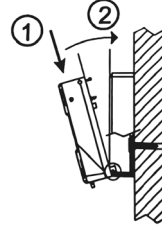
**3**

Place the unit onto the backbox and seal them with the screw at the bottom.

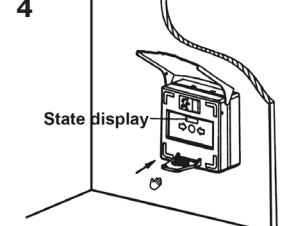
**4**

Insert the key into the key hole. Pull the key out when the LED turns green to complete the installation.



For queries visit our website [www.cdvi.co.uk](http://www.cdvi.co.uk) or contact us at:  
**sales@cdvi.co.uk**  
**+44 1628 531300**